

# DURA-ACE Caliper Brake BR-7900

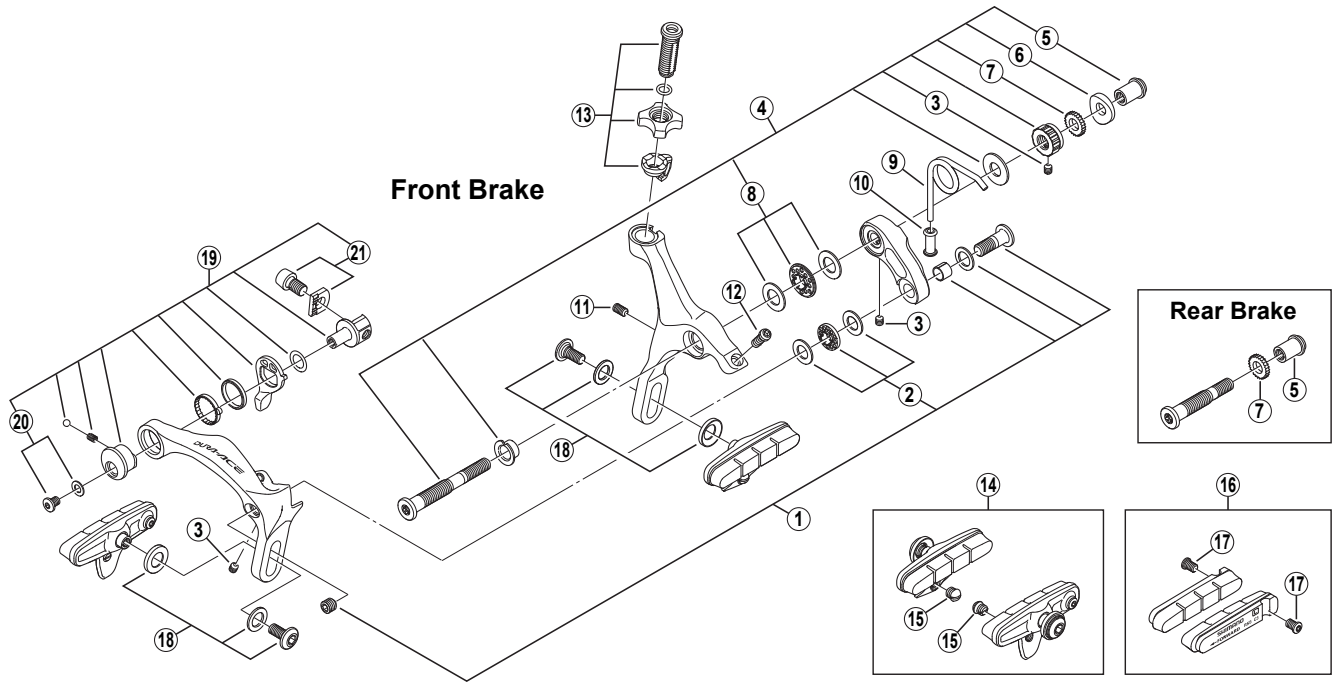

BR-7800  
BR-6600

ITEM NO.	SHIMANO CODE NO.	DESCRIPTION	INTERCHANGEABILITY	
1	Y-8FN 98010	Arm Bolt Unit (M6 x 17.5)		
2	Y-8A0 98060	Ball Retainer Unit (φ6)	A	
3	Y-884 14100	Set Bolt (M4)	A	
4	Y-8FN 98020	Front Pivot Bolt Assembly { Pivot Bolt: 52.5mm (2-1/16") / Pivot Nut: 10.5 mm }		
	Y-8FN 98030	Front Pivot Bolt Assembly { Pivot Bolt: 52.5 mm (2-1/16") / Pivot Nut:12.5 mm }		
	Y-8FN 98040	Front Pivot Bolt Assembly { Pivot Bolt: 52.5 mm (2-1/16") / Pivot Nut:18.0 mm }		
	Y-8FN 98050	Front Pivot Bolt Assembly { Pivot Bolt: 52.5 mm (2-1/16") / Pivot Nut:27.0mm }		
5	Y-8FN 98060	Rear Pivot Bolt Assembly { Pivot Bolt: 37.8 mm (1-1/2") / Pivot Nut:10.5 mm }		
	Y-855 75310	Pivot Nut (10.5 mm) for Front / Rear	B	B
	Y-855 75320	Pivot Nut (12.5 mm) for Front	B	B
	Y-855 74310	Pivot Nut (18.0 mm) for Front	B	B
	Y-8A0 23200	Pivot Nut (27.0 mm) for Front	B	B
6	Y-855 27000	R-Washer for Front	A	
7	Y-870 08100	Set Washer (φ12)	A	
8	Y-84B 98050	Ball Retainer Unit (φ7)	A	A
9	Y-8FN 10000	Arm Spring		
10	Y-84B 11000	Sleeve	A	
11	Y-8BW11100	Arm Spring Adjusting Bolt	A	
12	Y-8FA 09000	EC-Bolt (M4 x 10.2)	A	B
13	Y-8FN 98100	Cable Adjusting Bolt Unit		
14	Y-8FN 98070	R55C3 Cartridge-Type Brake Shoe Set (Pair)	B	B
15	Y-8FA 16000	Tire Guide	A	A
16	Y-8FN 98090	R55C3 Cartridge-Type Brake Shoes & Fixing Bolts (Pair)	B	B
	Y-8FA 98140	R55C Cartridge-Type Brake Shoes & Fixing Bolts (Pair) for Carbon Rim		
17	Y-8FA 17000	Fixing Bolt (M4 x 5.5)	A	A
18	Y-8FN 98080	Shoe Fixing Bolt Unit (M5 x 11.2)	B	B
19	Y-8FN 98110	Quick Release Assembly		
20	Y-8FA 98110	Quick Release Fixing Bolt (M4 x 4.8) & Washer	A	
21	Y-8A0 98150	Cable Fixing Bolt (M6 x 8.5) & Plate	A	

A: Same parts.

B: Parts are usable, but differ in materials, appearance, finish, size, etc.

Absence of mark indicates non-interchangeability.

0807-2868

Specifications are subject to change without notice.

# SHIMANO