

# TIAGRA Cassette Sprocket CS-HG50-9 9-Speed

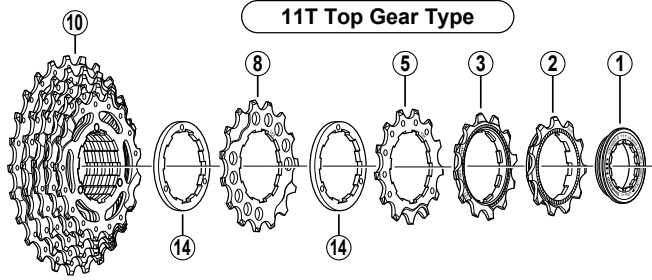

11T Top Gear Type

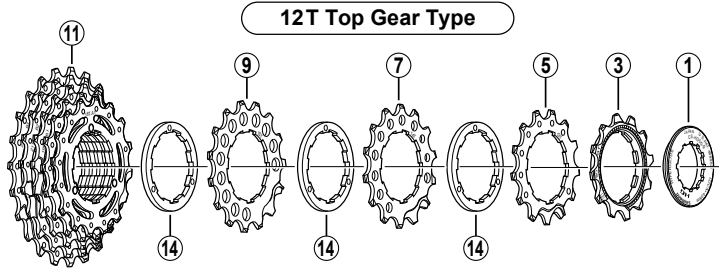

12T Top Gear Type

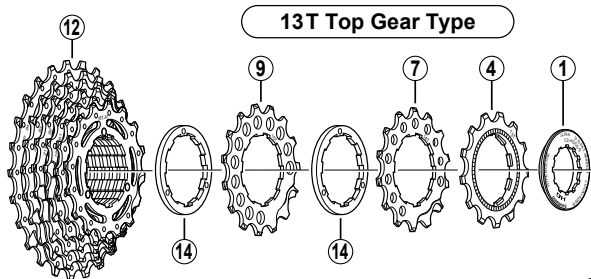

13T Top Gear Type

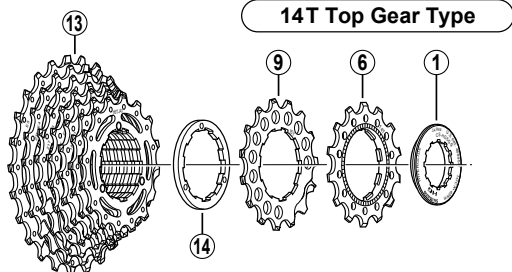

14T Top Gear Type

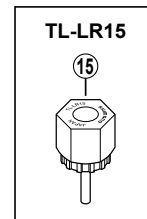

## CS-HG50-9 sprocket teeth combinations

11 – 25T	11 – 12 – 13	– 15 –	17 – 19 – 21 – 23 – 25 T
12 – 23T	12 – 13 – 14 – 15 –	16 – 17 – 19 – 21 – 23 T	
12 – 25T	12 – 13 – 14 – 15 –	17 – 19 – 21 – 23 – 25 T	
13 – 25T	13 – 14 – 15 –	16 – 17 – 19 – 21 – 23 – 25 T	
14 – 25T	14 – 15 –	16 – 17 – 18 – 19 – 21 – 23 – 25 T	

CS-HG70-9  
CS-6500

ITEM NO.	SHIMANO CODE NO.	DESCRIPTION	INTERCHANGEABILITY	
* 1	<b>Y-10B 98050</b>	Lock Ring for 11T Top Gear		B
	<b>Y-10B 01000</b>	Lock Ring	B	B
* 2	<b>Y-10R 11901</b>	Sprocket Wheel 11T (Built in spacer type)		B
3	<b>Y-10R 12001</b>	Sprocket Wheel 12T (Built in spacer type)	A	B
4	<b>Y-10P 13001</b>	Sprocket Wheel 13T (Built in spacer type)	A	B
5	<b>Y-10R 13001</b>	Sprocket Wheel 13T	A	B
6	<b>Y-10P 14001</b>	Sprocket Wheel 14T (Built in spacer type)		B
7	<b>Y-10R 1400E</b>	Sprocket Wheel 14T	B	B
* 8	<b>Y-10B 15G1H</b>	Sprocket Wheel 15T		
9	<b>Y-10R 1500E</b>	Sprocket Wheel 15T	B	B
* 10	<b>Y-10B 98060</b>	Sprocket Unit (17 – 19 – 21 – 23 – 25T)		
11	<b>Y-10B 98010</b>	Sprocket Unit (16 – 17 – 19 – 21 – 23T)	B	
	<b>Y-10B 98020</b>	Sprocket Unit (17 – 19 – 21 – 23 – 25T)	B	
12	<b>Y-10B 98030</b>	Sprocket Unit (16 – 17 – 19 – 21 – 23 – 25T)	B	
13	<b>Y-10B 98040</b>	Sprocket Unit (16 – 17 – 18 – 19 – 21 – 23 – 25T)		
14	<b>Y-357 64251</b>	Sprocket Spacer (t = 2.56 mm)	B	B
* 15	<b>Y-120 09230</b>	Lock Ring Removal Tool (TL-LR15)	A	A

A: Same parts.

B: Parts are usable, but differ in materials, appearance, finish, size, etc.

Absence of mark indicates non-interchangeability.

0607-1880A

Specifications are subject to change without notice.

# SHIMANO