

XTR Cassette Sprocket

CS-M970 9-Speed ba/be/bd-Group

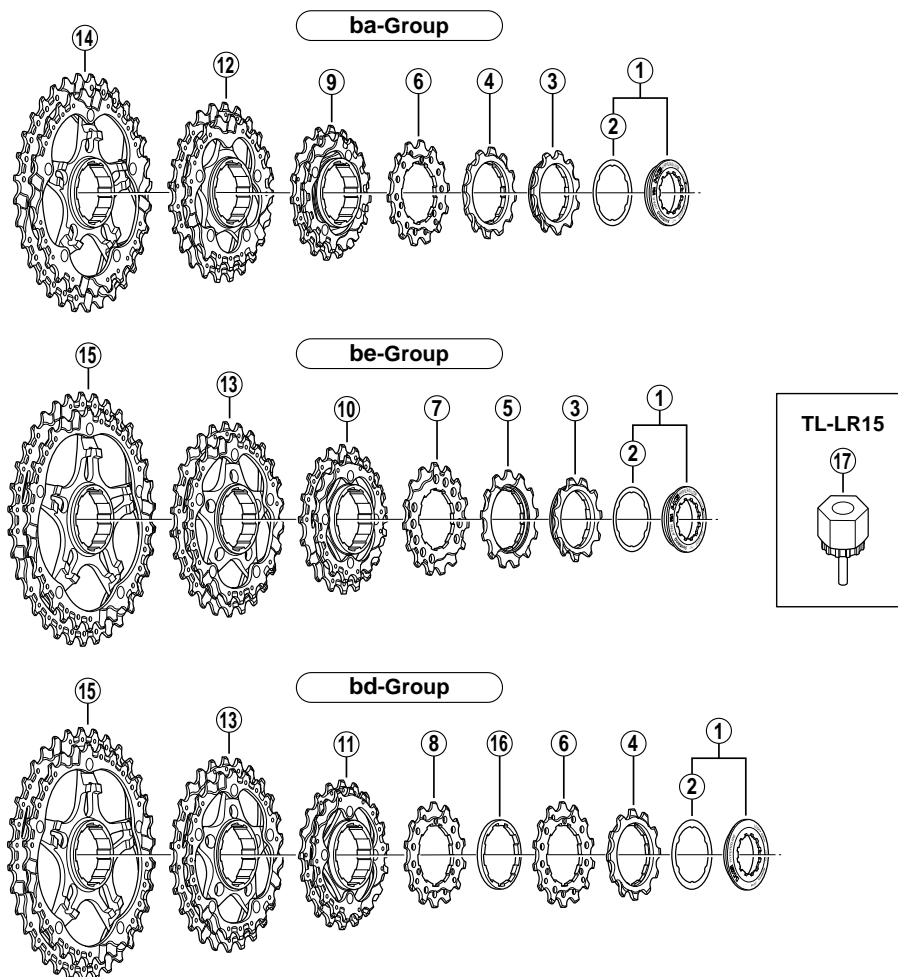

- **ba-group sprocket teeth combination:** 11 - 12 - 14 - 16 - 18 - 21 - 24 - 28 - 32T
- **be-group sprocket teeth combination:** 11 - 13 - 15 - 17 - 20 - 23 - 26 - 30 - 34T
- **bd-group sprocket teeth combination:** 12 - 14 - 16 - 18 - 20 - 23 - 26 - 30 - 34T

CS-M960

ITEM NO.	SHIMANO CODE NO.	DESCRIPTION	INTERCHANGEABILITY
1	Y-12M98010	Lock Ring & Spacer for ba/be-Group	B
	Y-12M98020	Lock Ring & Spacer for bd-Group	B
2	Y-10K 02000	Lock Ring Spacer for ba/be-Group	A
	Y-11W02000	Lock Ring Spacer for bd-Group	A
3	Y-10R 1161D	Sprocket Wheel 11T (Built in spacer type) for ba-Group	A
	Y-10K 1145D	Sprocket Wheel 11T (Built in spacer type) for be-Group	A
4	Y-10R 1261D	Sprocket Wheel 12T (Built in spacer type)	A
5	Y-10K 1345D	Sprocket Wheel 13T (Built in spacer type)	A
6	Y-10N 1444D	Sprocket Wheel 14T	A
7	Y-10K 1545D	Sprocket Wheel 15T	A
8	Y-10N 1644D	Sprocket Wheel 16T	A
9	Y-12M98030	Sprocket Unit (16 - 18T)	
10	Y-12M98040	Sprocket Unit (17 - 20T)	
11	Y-12M98050	Sprocket Unit (18 - 20T)	
12	Y-12M98060	Sprocket Unit (21 - 24T)	
13	Y-12M98070	Sprocket Unit (23 - 26T)	
14	Y-12M98080	Sprocket Unit (28 - 32T)	
15	Y-12M98090	Sprocket Unit (30 - 34T)	
16	Y-10R 03100	Sprocket Spacer (t=2.56 mm)	B
17	Y-120 09230	Lock Ring Removal Tool (TL-LR15)	A

A: Same parts.

B: Parts are usable, but differ in materials, appearance, finish, size, etc.
Absence of mark indicates non-interchangeability.

0606-2577

Specifications are subject to change without notice.

SHIMANO