

ACERA Front Chainwheel

**FC-M361-S** Silver Version  
**FC-M361-L** Black Version

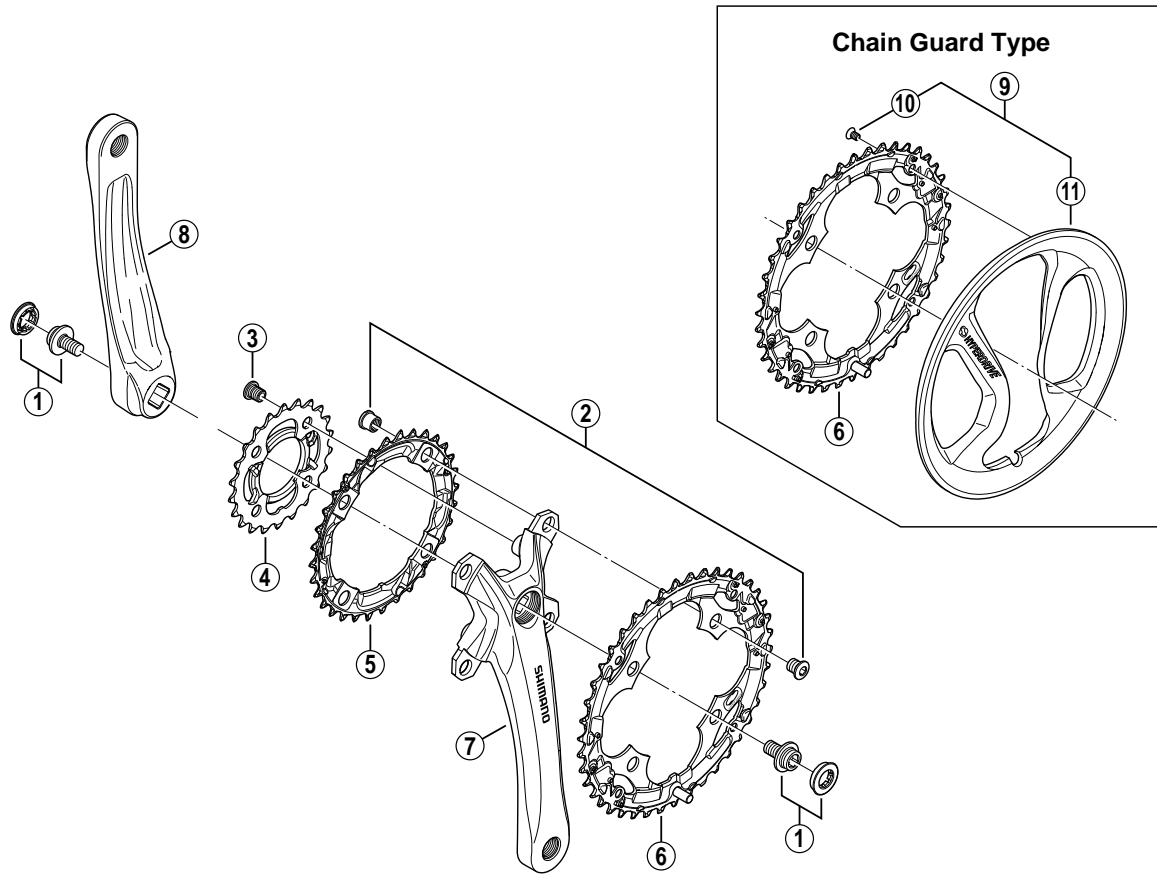

- Chaining teeth combinations: 42 - 32 - 22T / 48 - 38 - 28T
- Bolt circle diameter: 104 mm... (For outer gear and middle gear), 64 mm... (For inner gear)

FC-M361-S  
 FC-M341  
 FC-M311

ITEM NO.	SHIMANO CODE NO.	DESCRIPTION	INTERCHANGEABILITY
1	Y-16M 90100	Crank Arm Fixing Bolt & Cap	A
2	Y-1FM 98020	Double Gear Fixing Bolt (M8 x 8.5) & Nut (4 sets)	A A
3	Y-1FM 98030	Inner Gear Fixing Bolt (M8 x 8.5 / 4 pcs.)	A A
4	Y-1KN 98010	Chainring 22T (Black) & Chain Protector	A
	Y-1KN 98020	Chainring 28T (Black) & Chain Protector	
5	Y-1KN 98030	Chainring 32T (Black)	A
	Y-1KN 98040	Chainring 38T (Black)	
	Y-1KN 98050	Chainring 42T (Black)	A
6	Y-1KN 98060	Chainring 48T (Black)	
	Y-1KN 05000	Right Hand Crank Arm 170 mm (Silver) for FC-M361-S	
	Y-1KN 05010	Right Hand Crank Arm 170 mm (Black) for FC-M361-L	
7	Y-1KN 03000	Right Hand Crank Arm 175 mm (Silver) for FC-M361-S	
	Y-1KN 03010	Right Hand Crank Arm 175 mm (Black) for FC-M361-L	
	Y-1KN 05100	Left Hand Crank Arm 170 mm (Silver) for FC-M361-S	
	Y-1KN 05110	Left Hand Crank Arm 170 mm (Black) for FC-M361-L	
8	Y-1KN 03100	Left Hand Crank Arm 175 mm (Silver) for FC-M361-S	
	Y-1KN 03110	Left Hand Crank Arm 175 mm (Black) for FC-M361-L	
9	Y-1KN 98070	Chain Guard for 42T & Fixing Screws	A
	Y-1KN 98080	Chain Guard for 48T & Fixing Screws	
10	Y-1KN 98090	Chain Guard Fixing Screw (4 pcs.)	A
11	Y-1KN 12000	Chain Guard for 42T	A
	Y-1KN 13000	Chain Guard for 48T	

A: Same parts.

B: Parts are usable, but differ in materials, appearance, finish, size, etc.  
 Absence of mark indicates non-interchangeability.

0802-2793

Specifications are subject to change without notice.

**SHIMANO**