

# SPD Pedals PD-A520

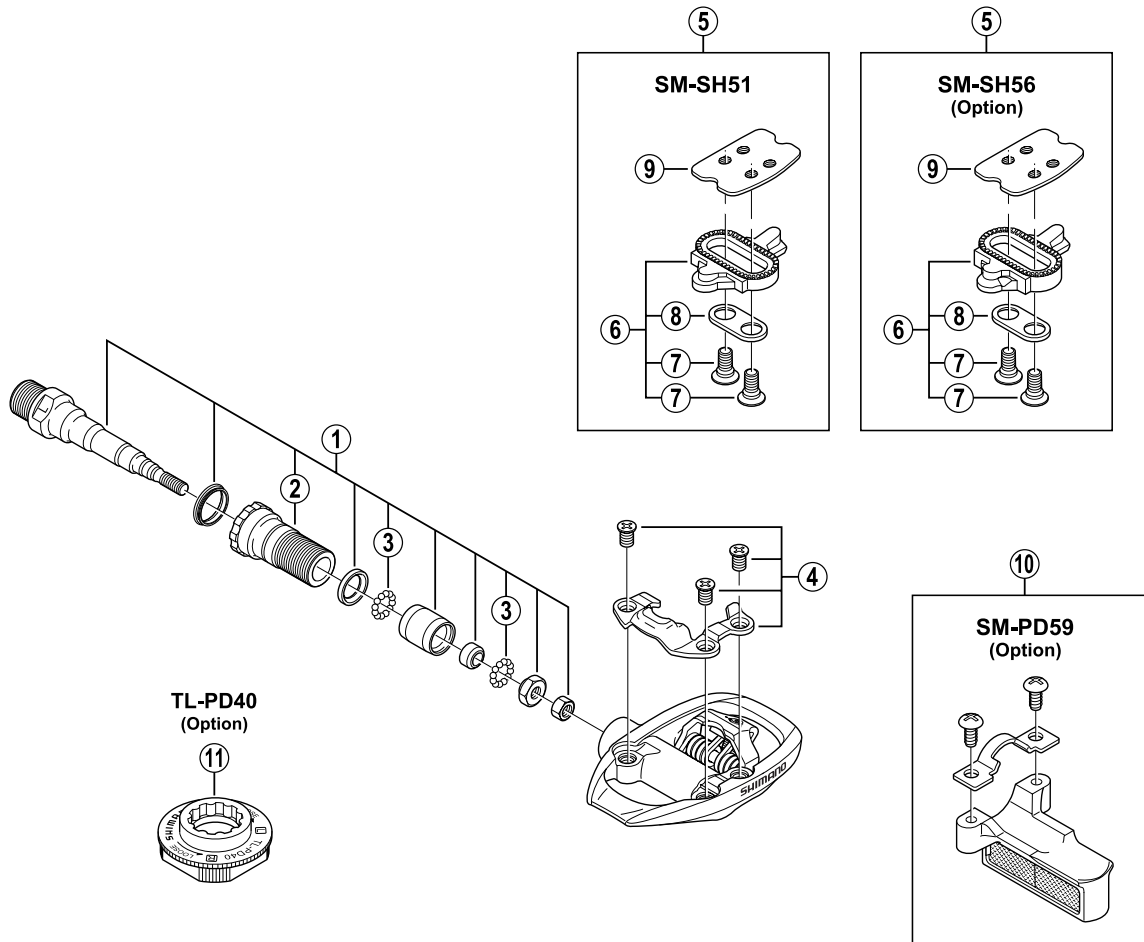

ITEM NO.	SHIMANO CODE NO.	DESCRIPTION
1	Y-45K 98010	Pedal Axle Assembly (Right / B.C.9/16" x 20T.P.I.)
	Y-45K 98020	Pedal Axle Assembly (Left / B.C.9/16" x 20T.P.I.)
2	Y-43Z 13100	Lock Bolt (Right)
	Y-43Z 14100	Lock Bolt (Left)
3	Y-41N 98030	Steel Ball (3/32") 62 pcs.
4	Y-41S 98050	Body Cover (Right) & Fixing Bolts
	Y-41S 98060	Body Cover (Left) & Fixing Bolts
5	Y-424 98200	SM-SH51 Cleat Set (Single Release Mode / Pair)
	Y-41S 98090	SM-SH56 Cleat Set (Multiple Release Mode / Pair)
6	Y-424 98201	SM-SH51 Cleat Set w/o Cleat Nut (Single Release Mode / Pair)
	Y-41S 98100	SM-SH56 Cleat Set w/o Cleat Nut (Multiple Release Mode / Pair)
7	Y-417 04030	Cleat Fixing Bolt (1 pc.)
8	Y-424 23000	Cleat Adapter (1 pc.)
9	Y-40N 01000	Cleat Nut (1 pc.)
10	Y-40R 98090	SM-PD59 Reflector Unit (Pair)
	Y-40R 98100	SM-PD59 Reflector Unit (AS / Pair)
11	Y-42A 09000	TL-PD40 Special Tool

0410-2422