

SHIMANO 105 Cassette Sprocket

CS-5700 10-Speed

11T Top Gear Type

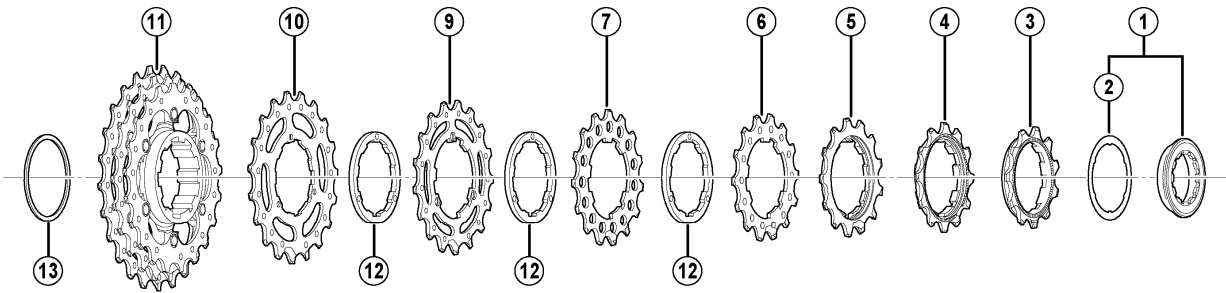

12T Top Gear Type

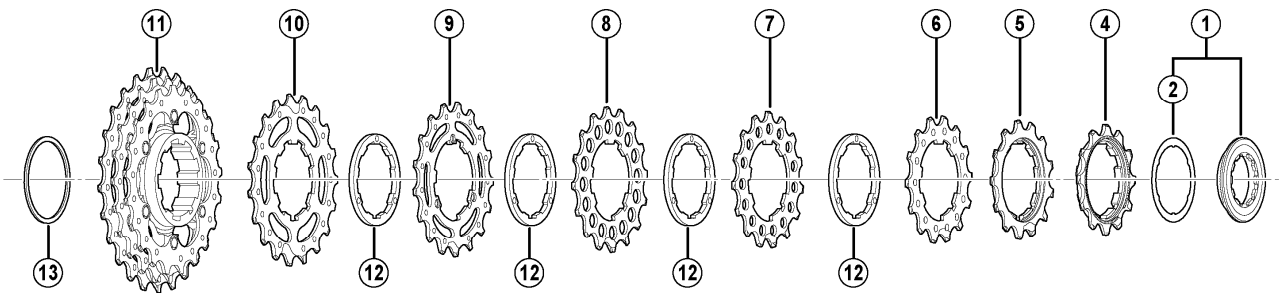

CS-5700 sprocket teeth combinations

11 - 25 T	11 - 12 - 13 - 14 - 15 - 17 - 19 - <u>21 - 23 - 25</u> T
11 - 28 T	11 - 12 - 13 - 14 - 15 - 17 - 19 - <u>21 - 24 - 28</u> T
12 - 25 T	12 - 13 - 14 - 15 - 16 - 17 - 19 - <u>21 - 23 - 25</u> T
12 - 27 T	12 - 13 - 14 - 15 - 16 - 17 - 19 - <u>21 - 24 - 27</u> T

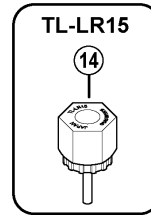

CS-5700

CS-5600

	SHIMANO CODE NO.	DESCRIPTION	INTERCHANGEABILITY		
1	Y1YN98010	Lock Ring & Spacer for 11T Top Gear			
	Y1YN98020	Lock Ring & Spacer for 12T Top Gear			
2	Y10Z04000	Lock Ring Spacer for 11T Top Gear	A	A	
	Y11W02000	Lock Ring Spacer for 12T Top Gear	A	A	
3	Y1Z81100N	Sprocket Wheel 11T (Built in spacer type)			A
4	Y1Z81200N	Sprocket Wheel 12T (Built in spacer type)			A
5	Y1ZD1390N	Sprocket Wheel 13T (Built in spacer type)			A
6	Y1Z81400N	Sprocket Wheel 14T			A
7	Y1Z81500N	Sprocket Wheel 15T			A
8	Y1Z81600N	Sprocket Wheel 16T			A
9	Y1ZF1700N	Sprocket Wheel 17T for 11T Top Gear			A
	Y1ZD1700N	Sprocket Wheel 17T for 12T Top Gear			A
10	Y1ZF1900N	Sprocket Wheel 19T for 11T Top Gear			A
	Y1ZD1900N	Sprocket Wheel 19T for 12T Top Gear			A
11	Y1YN98050	Sprocket Unit (21-23-25T) for 11-25T			
	Y1YN98060	Sprocket Unit (21-24-28T) for 11-28T			
	Y1YN98070	Sprocket Unit (21-23-25T) for 12-25T			
	Y1YN98080	Sprocket Unit (21-24-27T) for 12-27T			
12	Y35765231	Sprocket Spacer (t=2.35 mm)			A
13	Y1Z807000	Low Spacer (t=1.0 mm)	A	A	
14	Y12009230	Lock Ring Removal Tool (TL-LR15)	A	A	

A: Same parts.

B: Parts are usable, but differ in materials, appearance, finish, size, etc.

Absence of mark indicates non-interchangeability.

Mar.-2010-3016

© Shimano Inc. A

Specifications are subject to change without notice.

SHIMANO